



28 Meadow Chase Crescent

Barrow-In-Furness, LA13 0FA

Asking Price £275,000



28 Meadow Chase Crescent

Barrow-In-Furness, LA13 0FA

Asking Price £275,000



We are pleased to present this three bed semi-detached property situated within this popular and well established development. The property showcases modern kitchen and bathroom suites, and benefits from three spacious bedrooms, one with en-suite. Off road parking for at least two cars, and a large private rear garden. The home is presented in turn-key condition ready to move straight into, featuring neutral decor throughout and suiting a range of buyers. Available with no upper chain.

This modern semi-detached family home offers a practical and beautifully balanced layout across two floors. Upon arrival at the property you are greeted with a large front drive suitable for at least two cars.

Enter the ground floor into a neat and practical entrance hallway perfect for hanging up coats and storing shoes. The stairs are positioned ahead. To your left, a spacious lounge creates a comfortable and bright main living room. Towards the centre of the property is a handy ground-floor WC with a toilet and washbasin. Close by is a practical understairs storage cupboard space. Spanning the entire width of the rear is a generous open-plan kitchen and dining room, which is fully equipped with high quality built-in NEFF cooking facilities, integrated fridge-freezer, and an abundance of worktop and cupboard space. The room is completed by double patio doors which provide plenty of bright light to the room.

The private rear garden provides an enclosed space, perfect for dogs and children. It features an immaculate paved area perfect for outdoor furniture and a large astro-turfed area for low maintenance green appeal.

Upstairs, the first floor features a central landing with a dedicated storage cupboard. The primary bedroom sits at the front of the house where stunning countryside views can be seen from the window. The primary bedroom also offers the convenience of a private en-suite shower room with a toilet, shower and washbasin. Two additional bedrooms are located toward the rear of the property and overlook the rear garden and trees beyond. These rooms provide great flexibility for family members or a home office space. Completing the first-floor layout is a modern family bathroom fitted with a shower-bath, toilet, and washbasin.

Lounge

14'6" x 13'1" (4.44 x 4)

Kitchen/ Diner

16'5" x 9'11" (5.02 x 3.04)

WC

4'1" x 5'6" (1.27 x 1.70)

Bedroom One

11'3" x 9'8" (3.45 x 2.96)

Ensuite

5'5" x 6'4" (1.67 x 1.95)

Bedroom Two

10'0" x 9'2" (3.05 x 2.80)

Bedroom Three

10'0" x 6'10" (3.06 x 2.09)

Bathroom

7'4" x 5'6" (2.26 x 1.70)



- No Upper Chain
- Desirable Position on the Development
 - En-Suite Master Bedroom
 - Private Rear Garden
 - Neutral Modern Decor

- Countryside Views
- Three Bedrooms
- Downstairs WC
- Double Driveway
- Close To Schools and Co-op



Road Map

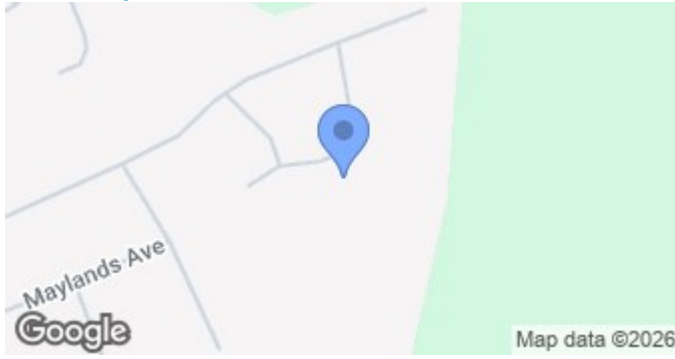

Terrain Map

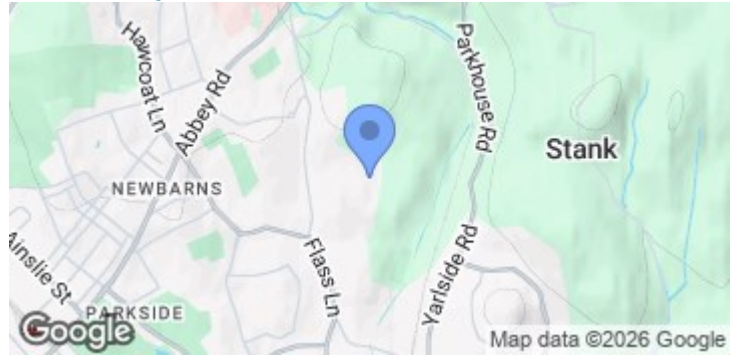

Floor Plan

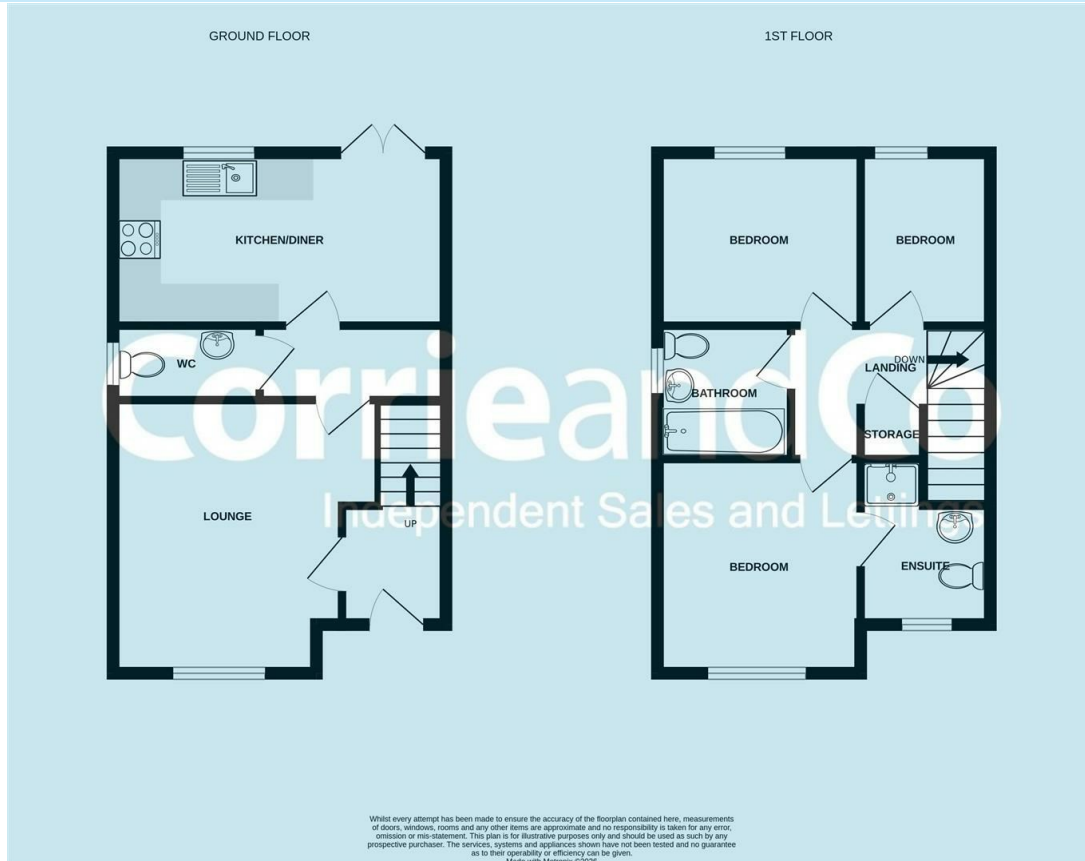

We are local, family run business who are wholly independent which means we can recommend services to most suit your needs. Our aim is to provide quality advice and expertise at all times, so you can make an informed decision whether buying or selling.

Estate agents are required by law to check a buyers /sellers identity to prevent Money Laundering and fraud. You do have to produce documents to prove your identity or address and information on your source of funds. Checking this information is a legal requirement to help safeguard your transaction, and failing to provide ID could cause delays. Corrie and Co, outsource these checks to speed up the process. The company does charge for such checks, please ask for more information and guidance on associated costs.

To ensure your move is stress free, we can help with Mortgage advice. We work alongside local Solicitors, offering competitive conveyancing services. Ask for further information.

